

Call for candidates 2020.002

<http://www.sncb-technics-sales.eu/en/content/current-sales>

Rolling stock:

M4m coaches



Contents

Art.1	Summary	2
Art.2	Application.....	3
Art.3	Grounds for exclusion	4
Art.4	Criteria	5
Art.5	Documentation supplied.....	6
Art.6	Visit.....	6
Art.7	Asbestos – Chromium 6	7
Art.8	Collection and transportation of the vehicles	7
Art.9	Technical sheets	9
Art.10	Photos	14
Art.11	Asbestos inventory.....	16
Appendixes:		
1.	Statement of intent	
2.	Summary of the asbestos wastes produced	
3.	Application form	

Art.1 Summary

1. In the course of 2020 and the following years, the SNCB plans to progressively withdraw from service more than 500 M4m-type coaches (hereinafter called : the “coaches” or “stock”).

The M4 coaches were constructed in the years 1979-1984 by La Brugeoise et Nivelles (BN) and modernised during the years 1996-2009. Their original bordeaux red colour changed to grey and the interior was completely renewed. Now they are called type M4m (m stands for modernized).

Because of the simplicity and trustworthy of these coaches, they are deployed on the entire Belgian train network, in particular during peak hours on the lines from and to Brussels. These coaches are so suitable to transport a big amount of people because the 2nd class coaches dispose of large two-seat benches that can seat three people when necessary during a busy time of the day.

Sometimes these coaches are referred to as ‘mirror palace’, as you can find a lot of mirrors on the sidewalls of the 2nd class coaches (see pictures under Article 10 of this document).

Since the coaches M4m are currently still partly in service and these coaches are very sustainable, we are looking to sell the coaches for reuse.



Construction year	1979-1984
Number	573
Maximum speed (km/h)	160
Weight (tons)	38-40
Number of seats	104
International journeys	No
Modernized	1996-2009

2. All specifications regarding the sale of the coaches are stated in this document. Should there be a need for extra information or clarification, please contact the following persons:

Inse Vandevyvere, +32 2 528 37 78 , inse.vandevyvere@belgiantrain.be

Nathalie Tesch, +32 2 526 30 37 , nathalie.tesch@belgianrail.be

3. The stock is sold in the condition well known by the buyer, who is expected to have informed himself thereof. Under no circumstances does the SNCB guarantee the absence of apparent or hidden defects in the stock, or its operability.

The weight stated in the technical specifications is for information purposes only and is not guaranteed.

4. Until the sales contracts have been concluded, the SNCB reserves the right to terminate the call for offers and withdraw the stock from sale.

The SNCB reserves the right, at any time, to change its policy and the schedule to withdraw the M4m coaches from service.

5. This call for applications procedure is governed exclusively by Belgian law. Only the courts of Brussels have jurisdiction.
6. The Rolling Stock in question contains one or more of the asbestos fibers referred to in Article 2 of the Belgian Royal Decree of 23 October 2001 limiting the sale and use of certain dangerous substances and products (i.e. asbestos).

The Rolling Stock may also contain other substances of which the processing is subject to the Well-being at Work Code.

7. As this stock contains asbestos, the actual sale can only take place after all asbestos has been removed from the vehicles by the Buyer or the company designated by the Buyer and after approval of the required documents certifying the asbestos removal.
8. Each selected prospective buyer shall pay a guarantee to the SNCB which is equivalent to 80% of the sales price for the purchased coaches upon conclusion of the sales contract and before their collection. The invoicing shall take place after the receipt of the required documents concerning the asbestos removal from the approved company agreed in the contract (see Art. 11).

Art.2 Application (see Appendix 3)

2.1. Prospective buyers must remit an application following the template in the annex, in French, Dutch or English. Applications will not be accepted in any other language.

The application is confidential and the SNCB agrees not to disclose any information contained within the file.

2.2. In order to be approved, the following information is mandatory in the application:

1. The official details of the potential Buyer (name, company type, headquarter address et company registration nr)
2. Contact persons, their functions and contact details (address, phone nr and @) of the candidate-buyer
3. The company's financial records
 - a. The turnover for the last 3 full financial years (balance-sheet)
 - b. The company's gross margin for the last three full financial years
 - c. The number of employees during the last 3 full financial years
 - d. A financial report issued by the Credit Safe company in 2020

4. The details and official certificate, issued by the competent authorities, of the prospective buyer's chosen asbestos removal company. If the certificate is not written in French, Dutch or English, the prospective buyer must also submit a translation carried out by a sworn translator.
5. Statement of intent signed by the asbestos removal company proposed by the candidate-Buyer, constituting its commitment to the Buyer candidate, according to the model given in Appendix 1.
6. Examples of confirmed projects in the railway domain and explanation of experience acquired in this domain.
7. The number of coaches by type for which the application is being submitted.

2.3. The prospective candidate may give an indicative price in euros, per coach type, but this is optional.

In order for the prospective buyer to establish its indicative price(s) and the terms of collecting and transporting the coaches, the SNCB proposes to the candidates to visit coaches in use in the SNCB workshop of Forest (Brussels), in Belgium.

2.4. All applications must be sent to the SNCB by email only to technics.sales@belgiantrain.be. Applications received by other means of communication than the above email address will be inadmissible and rejected. The SNCB reserves the right to leave the bidding open as long as judged necessary.

2.5. After analysis of the applications, the SNCB shall select prospective buyers based on the grounds for exclusion and the criteria below, within one month after receipt of the application.

The result will be communicated to the selected prospective buyers by email (to the addresses provided in the application).

Art.3 Grounds for exclusion

3.1 Mandatory grounds for exclusion

The SNCB shall exclude from this process, at any part of the process whatsoever, a prospective buyer if the SNCB learns that said buyer has been convicted of one of the following infractions:

1. participation in criminal activity;
2. corruption;
3. fraud;
4. terrorist infractions, infractions related to terrorist activities or incitement to commit such an infraction, complicity in or attempt to commit such an infraction;
5. money laundering or the financing of terrorism;
6. child labour or other forms of human trafficking;
7. illegal residency of third country citizens in the country.

3.2. Grounds for exclusion related to fiscal and social debts

If the SNCB learns that a prospective buyer has not fulfilled its obligations regarding the payment of tax or social security contributions, the SNCB shall have the right to exclude this application, regardless of the stage of the selection process.

If the SNCB learns that a prospective buyer has not fulfilled its obligations regarding the payment of tax or social security contributions, the SNCB shall give a period of 5 business days to give the prove of his regularisation. This adaption can only be executed once.

3.3. Optional grounds for exclusion

Unless the prospective buyer demonstrates that sufficient measures have been taken to demonstrate its reliability, the SNCB may exclude any prospective buyer, at any stage of the selection process, in the following cases:

1. where the SNCB can demonstrate that the applicant failed to meet applicable obligations in the environmental, social or labour law domains;
2. where the applicant has been declared bankrupt, has ceased operations, has undergone judicial reorganisation or has filed for bankruptcy or is subject to a liquidation or judicial reorganisation procedure;
3. where the SNCB can demonstrate by any appropriate means that the applicant has committed gross professional misconduct that casts doubt on their integrity;
4. where the SNCB has sufficient plausible elements to conclude that the applicant has committed acts, concluded agreements or taken part in deals in view of distorting competition.
5. where significant or persistent failures of the prospective purchaser were found in the performance of an essential obligation on him under a previous contract, when these failures resulted in the termination of the contract, damages, or other comparable sanction;
6. where the prospective purchaser has made a false statement by providing the information required for the verification of the absence of grounds for exclusion or the satisfaction of the selection conditions, has withheld this information or is not in The measure of submitting the required supporting documentation;
7. where the prospective purchaser has undertaken to unduly influence the decision-making process of the SNCB or to obtain confidential information that may give him an unfair advantage in this proceeding, or has negligently provided misleading information that may have a decisive influence on exclusion, selection or award decisions.

Selection and Award Criteria

4.1. Selection criteria of the prospective buyers

With respect of the grounds for exclusion in our article 3, the SNCB will accept the applications which provide the documents requested in the article 2 en which respond to the following criteria:

- ❖ Financial capability:
 - In reference to the financial data submitted in the application, as well as any relevant data that the SNCB may obtain from external sources.
 - A Credit Safe rating of at least 5/10 is required; where this is not the case, the company must provide additional guarantees to be admissible.

- ❖ Technical capability in regard to the Environment Rules: if the company does not disclose the identity and the contact details of the approved asbestos removal partner in their application and the proof that this company accepts the needed operations and the required documents to be remitted, the application will be refused.

4.2. Award criteria

All prospective buyer applicants who have submitted an admissible application and meet the award criteria will be contacted regarding the second phase of the sale.

Art.4 Documentation supplied

In addition to the information in this call for offers, the SNCB may supply the following documents, upon formal request from any prospective buyer, after signature of a non-disclosure agreement:

- The technical sheet on gauge
- The basic technical specifications
- The list of last revision dates of the coaches.

Upon conclusion of the sales contract between the SNCB and a prospective buyer, the SNCB agrees to supply the maintenance manual for each coach (if it is available).

Any other technical document desired by the buyer will be subject to a specific agreement between the parties.

Art.5 Visit

To arrange a visit to inspect the M4m in the workshop of Forest/Brussels, the prospective buyer can contact the following persons:

Inse Vandevyvere, +32 2 528 37 78 , inse.vandevyvere@belgiantrain.be
Nathalie Tesch, +32 2 526 30 37 , nathalie.tesch@belgiantrain.be

To be allowed access in the premises of SNCB with the intent to visit the rolling stock, a non-disclosure agreement will have to be signed by the prospective buyer.

Art.6 Asbestos – Chromium 6

7.1. The M4m coaches contain limited quantities of asbestos, primarily in the form of Klingerit wedges.

An inventory where the asbestos could be found is provided under Article 11 of present document, as indicative information only.

Asbestos removal must take place before the transfer of property. Asbestos removal will be performed according to a tripartite contract between the buyer, the SNCB and a certified asbestos removal company, suggested by the prospective buyer in their application, and approved by the SNCB.

According to this contract, a list documents is required certifying the asbestos removal. The description of these documents can also be found under Article 11 of this document.

The asbestos removal must take place after the collection of the stock by the buyer and within a maximum time period as agreed between the parties upon conclusion of the sales contract.

If the SNCB has not received the required documents of removal before the expiry of the agreed time period, the SNCB may either choose to:

- grant an additional time for the asbestos removal and communication of these documents, either by the Asbestos Remover or another asbestos remover (still to be borne by the Buyer) approved by SNCB and subscribing to the obligations of the Asbestos Remover; or
- terminate this Contract without judicial intervention or compensation at its expense, after sending a formal notice to the Buyer and Asbestos Remover. In this case, SNCB shall retain the guarantee as a fixed compensation, subject to the right of SNCB to claim a larger amount against evidence of a greater damage actually suffered.

7.2. The M4m coaches may contain chromium 6 in the paintwork present under the coach and on the roof. The prospective buyer will be solely responsible for compliance with all legal and regulatory obligations resulting from the presence of chrome 6 on the equipment, as soon as the risks are transferred.

7.3. The Rolling Stock may also contain other substances of which the processing is subject to the Well-being at Work Code, in particular under Chapter 2 of Book VI (workers' protection applicable to workers exposed to or likely to be exposed to carcinogenic, mutagenic and reprotoxic agents as a result of their work).

It is the responsibility of the Asbestos Remover and Buyer to comply with the obligations under the above legislation as employers, and they must in particular conduct a risk analysis for any activity likely to lead to the exposure to carcinogenic agents.

Art.7 Collection and transportation of the vehicles

The collection and transportation of the coaches is at the exclusive cost and under the exclusive responsibility of the buyer.

The eventual costs associated with the loading, transport and storage charged to Rolling Equipment (e.g., track occupancy costs) are at the charge of the Buyer from the time SNCB has made the Material available.

The buyer is responsible for informing the transporter of the condition of the stock and of the collection terms to avoid any subsequent discussion.

For the planning of the collection, an agreement must be concluded between the SNCB and the buyer to set out the procedure and timing of operations between the withdrawal from service and departure of the vehicles. This agreement will be part of the sales contract.

During the collection operation and transport of the coaches, the buyer and the carrier designated by him, if any, will at any time be solely responsible for compliance with the legal and regulatory provisions in force, including the regulations published by the SNCB and communicated to the buyer, related to the safety of persons and property, including the safety and protection of staff and third parties, and the protection of the environment.

The applicable security and environmental norms in all workshop facilities are to be scrupulously respected.

Art.8 Technical sheets

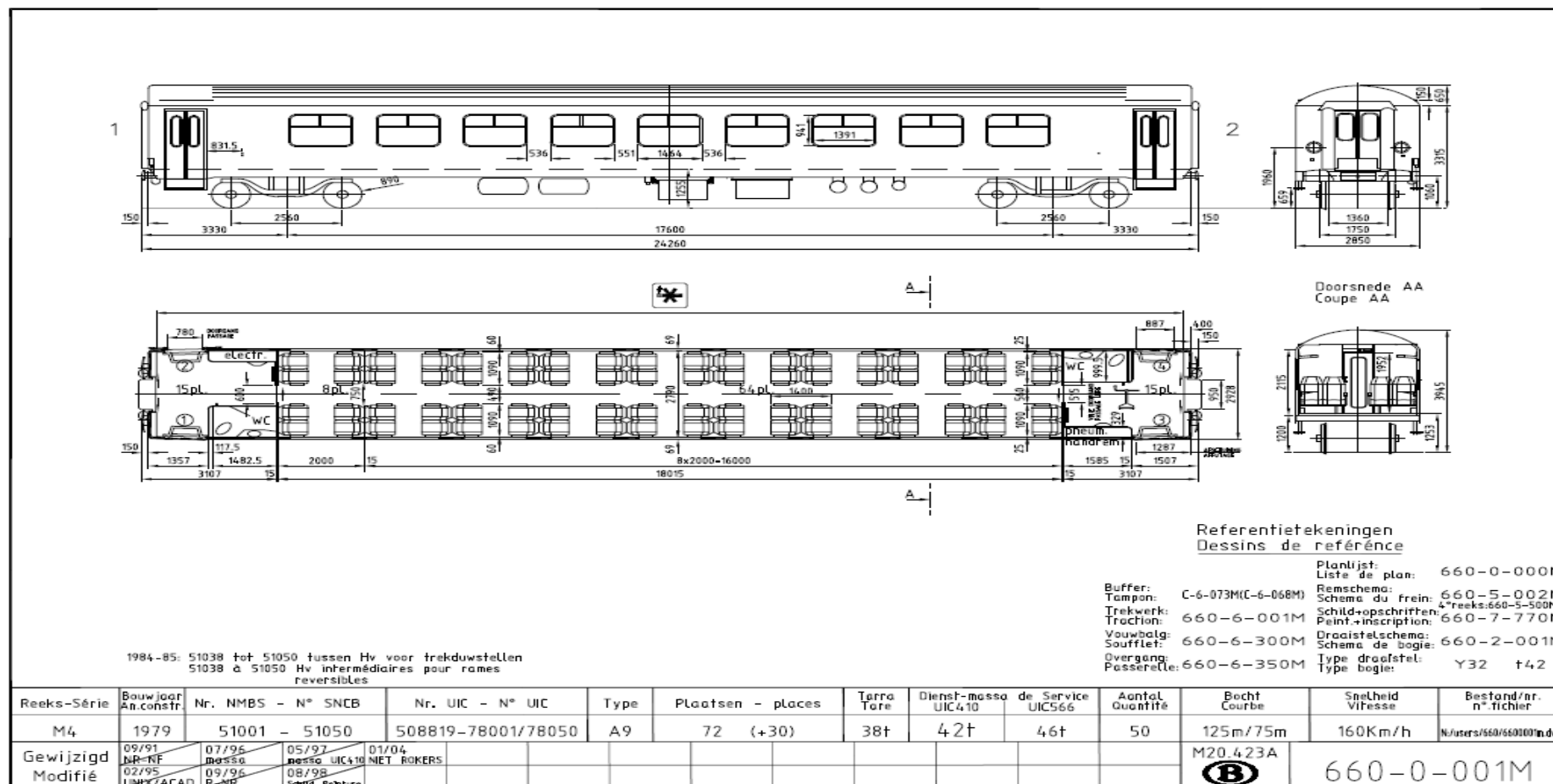

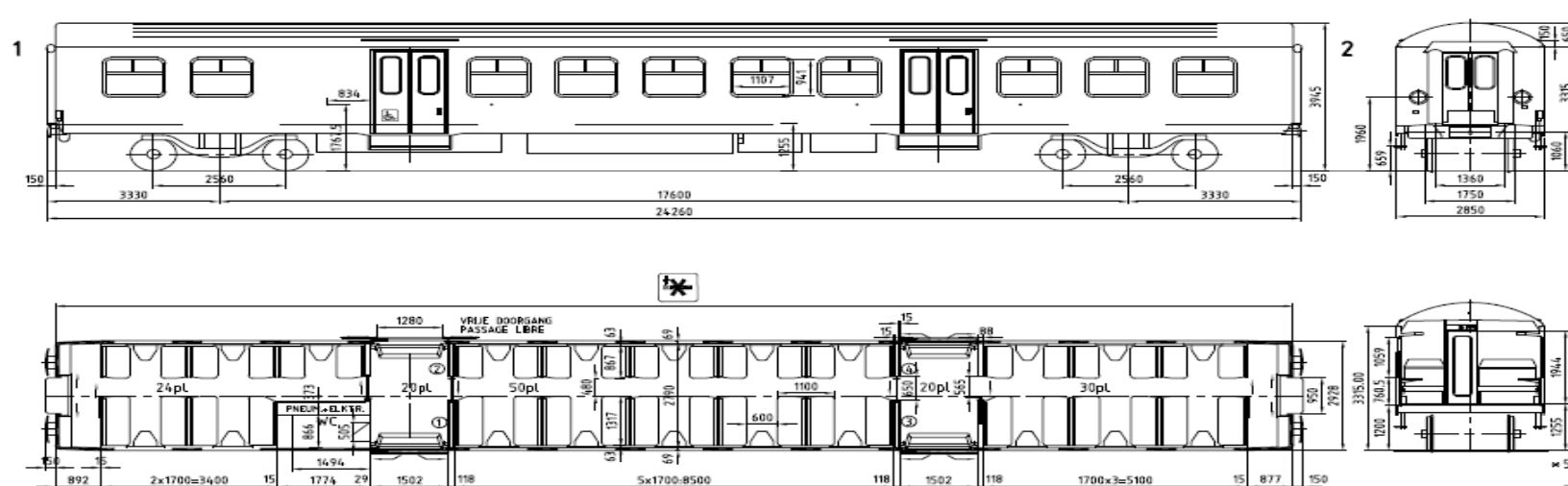

x 52096-52245:
661-S-300M
52246-52340:
661-S-602M
52341-52430:
661-S-602M

Referentietekeningen Dessins de référence

Planlijst: 661-0-000M
Liste de plan: 661-0-000M
Remschema: 661-S-002M
Schema du frein: 661-S-002M
Schild+opschriften: 661-7-770M
Peint+inscription: 661-7-770M
Draaischema: 660-2-001M
Schema de bogie: 660-2-001M
Type draaistel: Y31 t42
Type bogie: Y31 t42

Buffer: C-6-073MIC-6-068M
Tampon: C-6-073MIC-6-068M
Trekwerk: 660-6-001M
Traction: 660-6-001M
Vouwbalg: 660-6-300M
Soufflet: 660-6-300M
Overgang: 660-6-350M
Passerelle: 660-6-350M

2004: Alle Hv's NIET ROKERS
Toutes Les Hv NON FUMEURS
1996: Modernisatie CW Mechelen - 69 hv rokers zie 661-0-001Mbis
Modernisation AC Mollnes - 69 hv fumeurs voir 661-0-001Mbis
1984-85: 52248 tot 52430 tussen Hv voor trekdoustellen
uitgezonderd 52324
52248 à 52430 Hv intermédiaires pour rames
réversibles sauf 52324

Reeks-Série	Bouwjaar An.constr.	Nr. NMBS - N° SNCB	Nr. UIC - N° UIC	Type	Plaatsen - places	Terra Tere	Dienst-messa UIC410	de Service UIC566	Aantal Quantité	Bocht Courbe	Snelheid Vitesse	Bestand/nr. n° Fichier
M4	1979	52001 - 52430	508820-78001/78430	B11	104 (+40)	39t	45t	50t	357	125m/75m	160Km/h	Nusers/661-6610001ml.dwg
Gewijzigd Modifié	02/95 UNIX/ACAD 19/12/95	Perse-Passe 02/96 N-rok./N-fum. 10/96	Perse-UCAR 05/97 schild-opsch. 08/98	NET-ROKERS 01/2004 Aantal-Quantité 09/16						M20.423A B	661-0-001M	

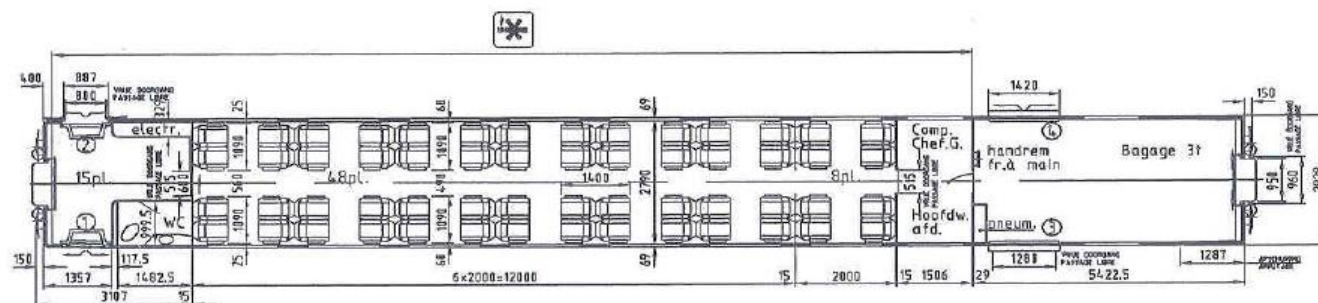
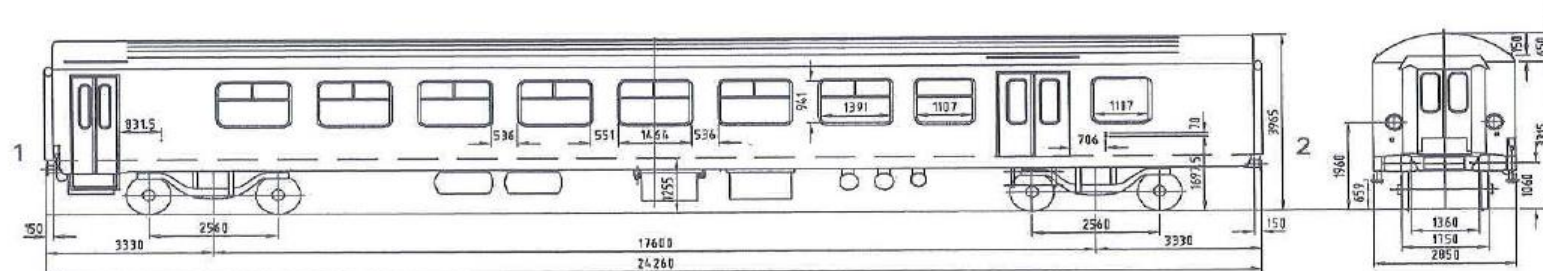

Referentietekeningen
Dessins de référence

Buffer:		Plantijst:	
Tampon:	C-6-073M(C-6-068M)	Liste de plan:	662-0-000M
Trekwerk:		Remschema:	
Tracering:	660-6-001M	Schema du frein:	662-5-002M
Vouwbalg:		Schild-opschriften:	
Soefflet:	660-6-300M	Peint-inscription:	662-7-770M
Overgang:		Draaislitschema:	
Passerelle:	660-6-350M	Schema de bagie:	660-2-001M
		Type draaisl:	
		Type bagie:	Y32 f42

Reeks-Série	Bouwjaar An	Nr. NMBS - N° SNCB	Nr. UIC - N° UIC	Type	Plaatsen - places	Terra Tare	Oienst-massa UIC 410	de Service UIC 566	Aantal Quantité	Baht Courbe	Snelheid Vitesse	Bestand/nr. n° fichier
M4	1981	58001 - 58033	508881-78001/78033	A7D	56 (+15)	38t	42t	47t	33	125m/75m	160Km/h	R:\users\662\662001m.dwg
Gewijzigd Modifié	UNIKACAD 02/95 massa-massa 02/95	massa UIC 410 12/97 Schild-Palshof 08/98	Roos-Modificatie 12/97 NET ROKERS 01/2004							M20.423A 	662-0-001M	

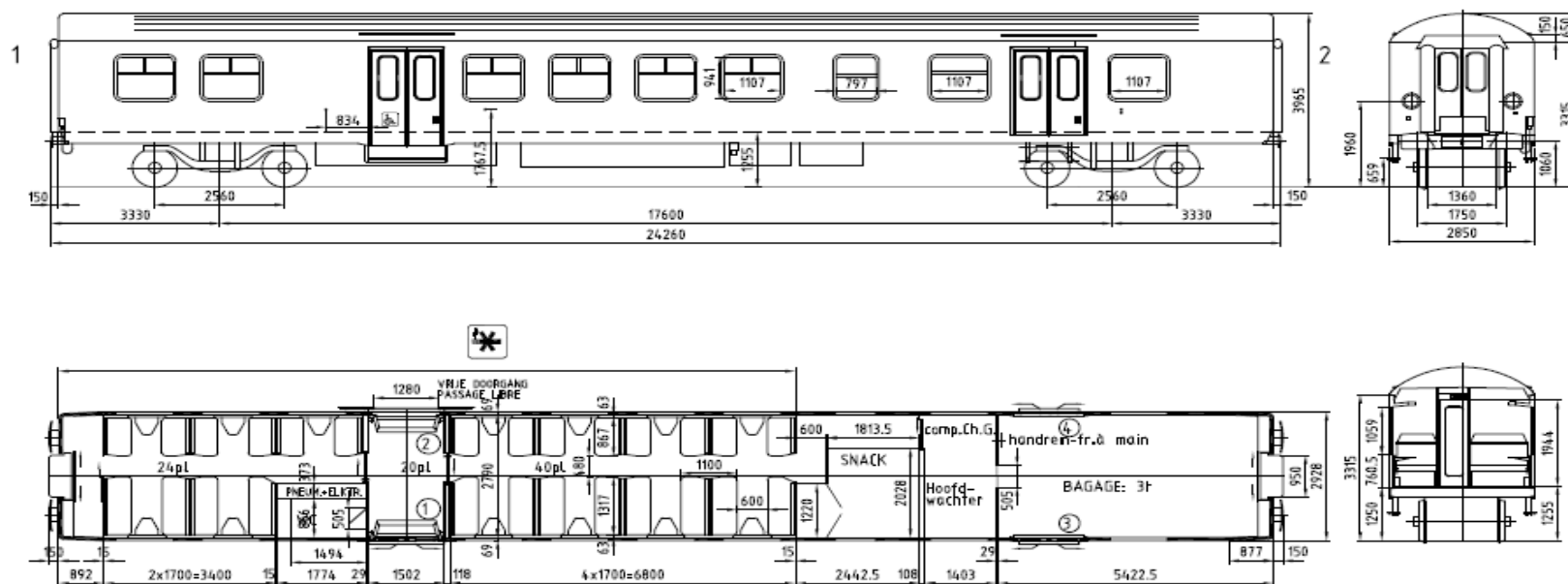

Referentietekeningen
Dessins de référence

Planlijst: 663-0-000M
Liste de plan: 663-0-000M
Remschema: 663-5-002M
Schema du frein: 663-5-002M
Schildopschriften: 663-7-770M
Peint.-inscriptions: 663-7-770M
Draaischema: 660-2-001M
Schema de bogie: 660-2-001M
Type draaistel: Y32 t42
Type bogie: Y32 t42

1984-85: B7Dk (59901-59935)
1988-89: 59926 tot 59935 tussen hv voor trekduwstellen.
59926 à 59935 Hv intermédiaires pour rames
reversibles.

Reeks-Série	Bouwjaar An.constr.	Nr. NMBS - N° SNCB	Nr. UIC - N° UIC	Type	Plaatsen - places	Terra Tare	Dienst-massa UIC410	de Service UIC566	Aantal Quantité	Bocht Courbe	Snelheid Vitesse	Bestand/nr. n°.richier
M4	1979	59901-59935	508887-78001/78035	B7Dk	64 (+20)	40t	45t	50t	35	125m/75m	160Km/h	%users/663/663000hndg
Gewijzigd Modifié	02/95 UNIX/ACAD massa-massa 07/96	massa UIC410 NET ROKERS 05/97 schild-Peinture 08/98	01/2004							M20.423A B	663-0-001M	

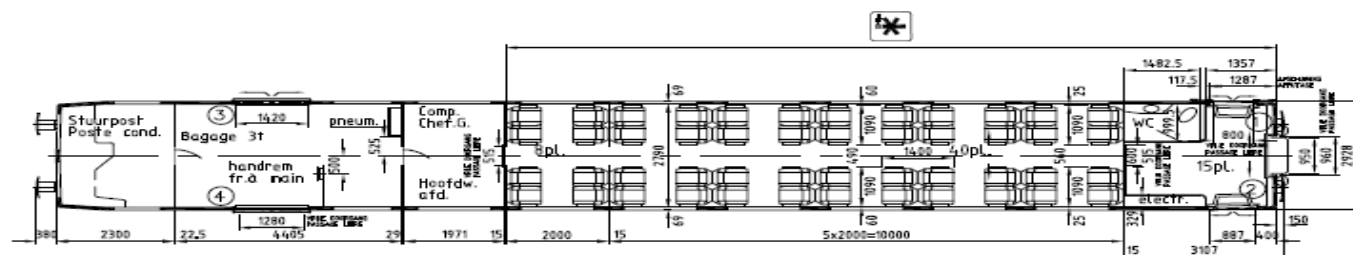
Referentietekeningen
Dessins de référence

Buffer: C-6-073M(C-6-068M)
 Trekwerk: 660-6-001M
 Vouwbalg: 660-6-300M
 Soufflet: 660-6-350M
 Overgang: 660-6-350M
 Passerelle: 660-6-350M

Plantlijst: 665-0-000M
 Liste de plan:
 Renschema: 665-5-002M
 Schema du frein:
 Schild-opschriften:
 Peint.-inscriptie: 665-7-770M
 Dooielschema: 660-2-001M
 Schema de bogie: SP: 665-2-001M :PC
 Type draaisel: Y32 t42
 Type bogie: SP: Y32 t43 :PC

M20.42
(B)

sncb



Art.9 Photos





Voitures M4 en livrée bordeaux.



Intérieur d'une voiture rénovée de 1^{re} classe.



Intérieur d'une voiture rénovée de 2^e classe.



Voiture-pilote en livrée bordeaux.



voiture de 1^{re} classe.



voiture de 2^e classe avec compartiment à bagages.

Art.10 Asbestos inventory

The table below provides an indicative inventory of zones that may contain asbestos in its different forms.

ref n°	Typ	N° voertuig	Plaats in rijtuig	Aard van de asbest	Toestand van het asbest	Plan - merk	Afmetingen (breed x hoog x leng)	Opmerkingen	N° RAPPORT ANALYSE	update
M4M-01	M4M	M4M Hv A n° (51001-51033) -AX n°(51034-51049) - B n°(52001-52044, 52048-52231, 52233-52243, 52245-52247)-BX n°(52248-52319, 52321-52351, 52353-52430)	plafond in afdeling	klingerit	gebonden	660-8-026M merk50	regelplaatje 30X2X80	90 X		
M4M-02	M4M	M4M Hv A n° (51001-51033) -AX n°(51034-51049) - B n°(52001-52044, 52048-52231, 52233-52243, 52245-52247)-BX n°(52248-52319, 52321-52351, 52353-52430)	plafond in afdeling	klingerit	gebonden	660-8-037M merk63	vulstrook 40X2X72	1 X zelfklevend rijtuigen M4-A		
M4M-03	M4M	M4M Hv A n° (51001-51033) -AX n°(51034-51049) - B n°(52001-52044, 52048-52231, 52233-52243, 52245-52247)-BX n°(52248-52319, 52321-52351, 52353-52430)	pneumatische kast	klingerit	gebonden	660-8-060M merk76	diktestuk1875X10X1,5	1 X rijtuigen M4-A		
M4M-04	M4M	M4M Hv A n° (51001-51033) -AX n°(51034-51049) - B n°(52001-52044, 52048-52231, 52233-52243, 52245-52247)-BX n°(52248-52319, 52321-52351, 52353-52430)	elektrische kast	klingerit	gebonden	660-8-061M merk81	strip 1870X10X1,5	1 X zelfklevend rijtuigen M4-A-AD-ADK		
M4M-05	M4M	M4M Hv A n° (51001-51033) -AX n°(51034-51049) - B n°(52001-52044, 52048-52231, 52233-52243, 52245-52247)-BX n°(52248-52319, 52321-52351, 52353-52430)	binnenbekleding houder zitbanken	klingerit	gebonden	660-8-063M merk68	dichting 50X2X70	1 x rijtuigen M4-A		
M4M-06	M4M	M4M Hv A n° (51001-51033) -AX n°(51034-51049) - B n°(52001-52044, 52048-52231, 52233-52243, 52245-52247)-BX n°(52248-52319, 52321-52351, 52353-52430)	scheidswanden van WC	klingerit	gebonden	660-8-102M merk74	strip 1875X10X1,5	2 X zelfklevend rijtuigen M4-A-AD		
M4M-07	M4M	M4M Hv A n° (51001-51033) -AX n°(51034-51049) - B n°(52001-52044, 52048-52231, 52233-52243, 52245-52247)-BX n°(52248-52319, 52321-52351, 52353-52430)	samenstelling W.C.	klingerit	gebonden	660-8-282M merk 2	strip 20X2X1800	1 X rijtuigen M4-A-A2-AD		
M4M-08	M4M	M4M Hv A n° (51001-51033) -AX n°(51034-51049) - B n°(52001-52044, 52048-52231, 52233-52243, 52245-52247)-BX n°(52248-52319, 52321-52351, 52353-52430)	samenstelling W.C.	klingerit	gebonden	660-8-282M merk3	strip 20X3X1800	1 X		
M4M-09	M4M	M4M Hv A n° (51001-51033) -AX n°(51034-51049) - B n°(52001-52044, 52048-52231, 52233-52243, 52245-52247)-BX n°(52248-52319, 52321-52351, 52353-52430)	opstelling verwarming op balkons	klingerit	gebonden	661-9.3-107M merk 1	6x isoleerband 17X2X290	idem. aan plan Nr. 660-8-282M rijtuigen M4-A-B-AD		
M4M-10	M4M	M4M Hv A n° (51001-51033) -AX n°(51034-51049) - B n°(52001-52044, 52048-52231, 52233-52243, 52245-52247)-BX n°(52248-52319, 52321-52351, 52353-52430)	opstelling verwarming op balkons	klingerit	gebonden	661-9.3-107M merk 2	6x op 25X2X340	idem. aan plan Nr. 660-8-282M rijtuigen M4-A-B-AD		
M4M-11	M4M	M4M Hv A n° (51001-51033) -AX n°(51034-51049) - B n°(52001-52044, 52048-52231, 52233-52243, 52245-52247)-BX n°(52248-52319, 52321-52351, 52353-52430)	opstelling verwarming op balkons	klingerit	gebonden	661-9.3-107M merk 3	4x scheidswand 17X2X280	idem. aan plan Nr. 660-8-282M rijtuigen M4-A-B-AD		
M4M-12	M4M	M4M Hv A n° (51001-51033) -AX n°(51034-51049) - B n°(52001-52044, 52048-52231, 52233-52243, 52245-52247)-BX n°(52248-52319, 52321-52351, 52353-52430)	opstelling verwarming op balkons	klingerit	gebonden	661-9.3-107M merk 4	4x scheidswand 25X2X280	idem. aan plan Nr. 660-8-282M rijtuigen M4-A-B-AD		
M4M-13	M4M	M4M Hv A n° (51001-51033) -AX n°(51034-51049) - B n°(52001-52044, 52048-52231, 52233-52243, 52245-52247)-BX n°(52248-52319, 52321-52351, 52353-52430)	opstelling verwarming op balkons	klingerit	gebonden	661-9.3-107M merk 5	4x scheidswand 60X2X920	idem. aan plan Nr. 660-8-282M rijtuigen M4-A-B-AD		
M4M-14	M4M	M4M Hv A n° (51001-51033) -AX n°(51034-51049) - B n°(52001-52044, 52048-52231, 52233-52243, 52245-52247)-BX n°(52248-52319, 52321-52351, 52353-52430)	opstelling verwarming op balkons	klingerit	gebonden	661-9.3-107M merk 7	4x scheidswand 17X2X480	idem. aan plan Nr. 660-8-282M rijtuigen M4-A-B-AD		
M4M-15	M4M	M4M Hv A n° (51001-51033) -AX n°(51034-51049) - B n°(52001-52044, 52048-52231, 52233-52243, 52245-52247)-BX n°(52248-52319, 52321-52351, 52353-52430)	opstelling verwarming op balkons	klingerit	gebonden	661-9.3-107M merk 8	4x scheidswand 25X2X480	idem. aan plan Nr. 660-8-282M rijtuigen M4-A-B-AD		
M4M-16	M4M	M4M Hv A n° (51001-51033) -AX n°(51034-51049) - B n°(52001-52044, 52048-52231, 52233-52243, 52245-52247)-BX n°(52248-52319, 52321-52351, 52353-52430)	opstelling verwarming op balkons	klingerit	gebonden	661-9.3-107M merk 9	2x scheidswand 25X3X290	idem. aan plan Nr. 660-8-282M rijtuigen M4-A-B-AD		
M4M-17	M4M	M4M Hv A n° (51001-51033) -AX n°(51034-51049) - B n°(52001-52044, 52048-52231, 52233-52243, 52245-52247)-BX n°(52248-52319, 52321-52351, 52353-52430)	opstelling verwarming op balkons	klingerit	gebonden	661-9.3-107M merk 20	4x scheidswand 25X2X970	idem. aan plan Nr. 660-8-282M rijtuigen M4-A-B-AD		
M4M-18	M4M	M4M Hv A n° (51001-51033) -AX n°(51034-51049) - B n°(52001-52044, 52048-52231, 52233-52243, 52245-52247)-BX n°(52248-52319, 52321-52351, 52353-52430)	opstelling verwarming op balkons	klingerit	gebonden	661-9.3-107M merk 26	4x scheidswand 25X2X510	idem. aan plan Nr. 660-8-282M rijtuigen M4-A-B-AD		
M4M-19	M4M	M4M Hv A n° (51001-51033) -AX n°(51034-51049) - B n°(52001-52044, 52048-52231, 52233-52243, 52245-52247)-BX n°(52248-52319, 52321-52351, 52353-52430)	opstelling verwarming op balkons	klingerit	gebonden	661-9.3-107M merk 34	24x op beugel 40X3X30	idem. aan plan Nr. 660-8-282M rijtuigen M4-A-B-AD		

M4M-20	M4M	M4M Hv A n° (51001-51033) -AX n°(51034-51049) - B n°(52001-52044, 52046-52231, 52233-52243, 52245-52247)-BX n°(52248-52319, 52321-52351, 52353-52430)	omkasting W.C. verwarming	klingerit	gebonden	660-9-3-108M merk18	dichting 20X2X1.000	rijtuigen M4-A-B-AD 1X		
M4M-21	M4M	M4M Hv A n° (51001-51033) -AX n°(51034-51049) - B n°(52001-52044, 52046-52231, 52233-52243, 52245-52247)-BX n°(52248-52319, 52321-52351, 52353-52430)	radiator W.C.	klingerit	gebonden	660-9-4-101M merk 23	isolatie 24X1 1X	rijtuigen M4-A-B-AD		
M4M-22	M4M	M4M Hv A n° (51001-51033) -AX n°(51034-51049) - B n°(52001-52044, 52046-52231, 52233-52243, 52245-52247)-BX n°(52248-52319, 52321-52351, 52353-52430)	verwarmingsgroep 13,2 kW rijtuig B	klingerit	gebonden	661-9-4-101M merk 25	dichting 1X	rijtuigen M4 B		
M4M-23	M4M	M4M Hv A n° (51001-51033) -AX n°(51034-51049) - B n°(52001-52044, 52046-52231, 52233-52243, 52245-52247)-BX n°(52248-52319, 52321-52351, 52353-52430)	verwarmingsgroep 13,2 kW rijtuig B	klingerit	gebonden	661-9-4-101M merk 41	vulplaat Ø 3 mm 1X	rijtuigen M4 B		
M4M-24	M4M	M4M Hv A n° (51001-51033) -AX n°(51034-51049) - B n°(52001-52044, 52046-52231, 52233-52243, 52245-52247)-BX n°(52248-52319, 52321-52351, 52353-52430)	Verwarmingsbatterij	klingerit	gebonden	660-9-4-103M merk 25	voeg 20X3			
M4M-25	M4M	M4M Hv A n° (51001-51033) -AX n°(51034-51049) - B n°(52001-52044, 52046-52231, 52233-52243, 52245-52247)-BX n°(52248-52319, 52321-52351, 52353-52430)	Verwarmingsbatterij	klingerit	gebonden	660-9-4-103M merk 41	voeg Ø 70			
M4M-26	M4M	M4M Hv A n° (51001-51033) -AX n°(51034-51049) - B n°(52001-52044, 52046-52231, 52233-52243, 52245-52247)-BX n°(52248-52319, 52321-52351, 52353-52430)	inrichting keuken kant H.W. afdeling	klingerit	gebonden	663-9-506M merk 10	isolatie 360X225X2	rijtuigen M4-BDK, 1X, achter de kookplaat		
M4M-27	M4M	M4M Hv A n° (51001-51033) -AX n°(51034-51049) - B n°(52001-52044, 52046-52231, 52233-52243, 52245-52247)-BX n°(52248-52319, 52321-52351, 52353-52430)	opstelling en aansluiting van remkranen	klingerit	gebonden	665-3-008M merk 25	voeg 1X	rijtuigen M4-Hle stuurrijtuig		
M4M-28	M4M	M4M Hv A n° (51001-51033) -AX n°(51034-51049) - B n°(52001-52044, 52046-52231, 52233-52243, 52245-52247)-BX n°(52248-52319, 52321-52351, 52353-52430)	binnendeuren	gerubberd karton	gebonden				2002/023	juin 2002
M4M-29	M4M	M4M Hv A n° (51001-51033) -AX n°(51034-51049) - B n°(52001-52044, 52046-52231, 52233-52243, 52245-52247)-BX n°(52248-52319, 52321-52351, 52353-52430)	wilstuk:: KLINGER n°80 @						5 81222	35370
M4M-30	M4M	M4M Hv A n° (51001-51033) -AX n°(51034-51049) - B n°(52001-52044, 52046-52231, 52233-52243, 52245-52247)-BX n°(52248-52319, 52321-52351, 52353-52430)	dichtingsgarmituur						70210	avril 97
M4M-31	M4M	M4M Hv A n° (51001-51033) -AX n°(51034-51049) - B n°(52001-52044, 52046-52231, 52233-52243, 52245-52247)-BX n°(52248-52319, 52321-52351, 52353-52430)	Adichting van de batterij van de verwarming						431/8170 7	août 88

It is the responsibility of the certified asbestos removal company, employed by the prospective buyer under its responsibility, to remove all asbestos for each coach in respect of the applicable regulations, in particular as regards the protection of employees.

Once the asbestos removal is complete, the Asbestos Removal Company shall send the following documents to SNCB:

1) an asbestos removal certificate which:

- details the places where asbestos was found and fully removed, expressly mentioning the type of asbestos found and removed (with photos) for each unit of the Rolling Stock;
- certifies for each unit of the Rolling Stock that the asbestos has been fully removed, based on the list established by the Asbestos Removal

Company; and,

- 2) a copy of any measurement reports performed, where applicable, in application of the provisions of Title 3 of Book IV of the Workplace Well-being Code;
- 3) a summary of asbestos waste following the template provided in Annex 2;
- 4) a copy of the receipt given to the Asbestos Removal Company by the approved dangerous waste collection company according to legislation on dangerous waste applicable in the region or country in question.

The receipt mentioned in point 4) above must contain at least the following information:

- 1) the date of transportation, delivery or, where applicable, the frequency of collection;
- 2) the name, address and company registration number of the Asbestos Removal Company, as well as the address at which the waste was treated, if different;
- 3) the name, address and company registration number or accreditation of the dangerous waste collection company;
- 4) the name, address and company registration number of the transporter(s), where applicable;
- 5) the name, company registration number and address of the place of business of the company to whom the waste was delivered;
- 6) the planned treatment method;
- 7) the quantity, in tons, in kilograms, in m3, or, where applicable, the summary of quantities collected;
- 8) the description of the waste;
- 9) the code indicated on the list of waste;
- 10) the composition and physical characteristics of the waste;
- 11) the type and number of packages;
- 12) special instructions relating to its transportation, if necessary.

This receipt shall be signed by the Asbestos Removal Company.

APPENDIX 1

Statement of intention

The Parties :

Company 1

Company 2

Name (prospective buyer)

Name (Asbestos Removal Company)

Address

Address

Represented by (name & function of the responsible person)

Represented by (name & function of the responsible person)

Statement of intention

Both parties commit to collaborate, according to the principles and procedures set out in the call for application no.2020.002, in case where the prospective buyer concludes a sale contract with the SNCB.

The signature of the present statement of intention does not in itself and at this stage entail any financial obligation between the Parties.

The Parties declare that they sign and will execute this statement of intention in good faith.

This statement is signed by the Parties for a period of three (3) years. It is tacitly reconducted.

Made on the in

Made on the in

For

For

Name of the responsible and titel

Name of the responsible and titel

APPENDIX 2

Summary of Asbestos Waste Produced

Production date	Name code (1)	Type (2)	Nature (3)	Quantity removed	Collection date	Name of the collector and transporter (4)	Receipt no. (5)	Disposal method (6)	Treatment: method and code (7)

(1) Waste product name and code

(2) Type of waste product:

- materials containing asbestos, friable or non-friable
- materials contaminated by asbestos
- non-contaminated materials

(3) Nature of the waste product: flocking, wood, scrap metal, heat insulating material, plates, plastics, etc.

(4) Name of the approved collector and transporter: specify the name and address

(5) Waste receipt issued by the approved collector: CMR no. (road certificate), collection slip no., etc.

(6) Specify the end destination and the intermediary destination(s) (collection centre, pretreatment centre, etc.): indicate the address(es)

(7) Treatment code

APPENDIX 3 - APPLICATION FORM – PAGE 1

No. 2020.002	Call for candidates: M4m coaches	
<p>I, the undersigned (Surname, First name, Role)</p>		
<p>Acting</p>		
<p><u>In my own name (1)</u> Residential address (street, no., post code, city, country) Tel no. (+ country code) Email: Bank account no.:</p>	<p>_____ _____ _____ _____ _____</p>	
<p><u>For the company (1)</u> Company name Address of registered office (street, no., post code, city, country) Company no.: Tel no. (+ country code): Email: Bank account no.:</p>	<p>_____ _____ _____ _____ _____ _____</p>	
<p><i>declare:</i></p> <p><i>hereby agree to:</i></p> <p><i>guarantee the SNCB, discharging them from any liability:</i></p> <p><i>declare</i></p> <p><i>Date and signature, preceded by the statement "Read and approved"</i></p>		<ul style="list-style-type: none"> ➤ <i>That I have examined the M4m show-coaches, representative of the lot mentioned below</i> ➤ <i>Respect the clauses and conditions of this Tender and the Terms and Conditions of the SNCB</i> ➤ <i>Pay the SNCB the sum corresponding to the total price for all awarded coaches</i> ➤ <i>Scrupulously respect applicable legislation on labour and environmental protection, and in terms of the safety of collection and transportation operations.</i> ➤ <i>Against any claim brought against it as a result, notably, of the use, storage, discharge, processing, transformation, transfer or elimination of the stock released for sale</i> ➤ <i>Against any possible recourse, for any negative consequences whatsoever resulting from accidents or any other causes, that could be suffered by:</i> <ul style="list-style-type: none"> - <i>"the buyer", moral or legal person, in person or their servants, and its or their stock;</i> - <i>third parties, including servants and representatives of the SNCB and their stock;</i> - <i>the SNCB, with regard to the goods it owns as well as those at its disposal. at all stages of the sale and any subsequent activity.</i> ➤ <i>That the stock shall be collected according to a specific agreement concluded with the SNCB</i> ➤ <i>The designation of the following approved company for asbestos removal:</i> <div style="background-color: #cccccc; height: 20px; width: 100%; margin-top: 5px;"></div>

APPENDIX 3 - APPLICATION FORM – PAGE 2 - 2020.002**The application must contain the following information:**

1. The official company details
2. Contact persons and details
3. The company's financial records
 - a. The turnover for the last 3 full financial years
 - b. The company's gross margin for the last three full financial years
 - c. The number of employees during the last 3 full financial years
 - d. A financial report issued by the Credit Safe company in 2020
4. The details and official certificate, issued by the competent authorities, of the prospective buyer's chosen asbestos removal company. If the certificate is not written in French, Dutch or English, the prospective buyer must also submit a translation carried out by a sworn translator.
5. Statement of intention from the asbestos removal company, according to the model in appendix 1.
6. Examples of confirmed projects and explanation of experience acquired in the railway domain.
7. The number of coaches by coach type for which the application is being submitted, with optionally a price in euros (offer per coach for each type)

Date and signature



APPENDIX 3 - APPLICATION FORM – PAGE 3 - M4m coaches – 2020.002

Coach type	Number available (theoretical quantity subject to revision)	Year of construction	Quantity of purchase	Application (offer per unit) in EURO EXC. VAT (optional)	
				In figures	Written in letters
1st class (cat.A) – without traction cable	33	1979-1981			
1st class (cat.A) – with traction cable	15	1979-1981			
2nd class (cat.B) – without traction cable	240	1980-1984			
2nd class (cat.B) – with traction cable	177	1984-1985			
1st class with luggage compartment (cat.AD) – without traction cable	32	1981-1982			
2nd class with luggage compartment (cat.BD) – without traction cable	25	1984			
2nd class with luggage compartment and kitchen (cat.BDk) – with traction cable	9	1984			
1st class with luggage compartment and driver's cab (cat. ADx)	30	1982			

Note: coaches with traction cables are coaches that can operate with type 21 locomotives because they are equipped with a reversibility cable.

Date and signature